

36'' Digital Tower Fan with DC Motor and WiFi

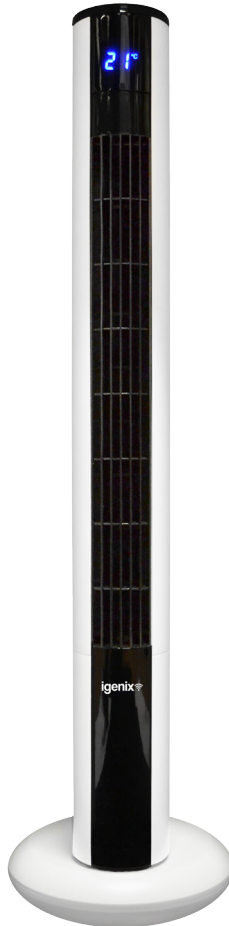

DF0038WIFI / DF0038BLWIFI

Batch code:

Please read these instructions carefully before use and retain for future reference

**Before switching on your appliance,
always check for any damage which may have been caused in transit**

CONTENTS

Safety Instructions.....	2-3
Appliance Overview	4
Operating Instructions.....	5
Setting up Wi-Fi Function.....	6-12
Cleaning & Storage	13
Fuse Replacement.....	13
Igenix Warranty	14-15
Disposal Information.....	16

SAFETY INSTRUCTIONS

Please read this user manual carefully to ensure proper use, maintenance and installation.

1. This product is intended for domestic and light office use **ONLY** and not for commercial, industrial or outdoor use.
2. Do not operate the unit with a damaged cord or plug, after it malfunctions or has been dropped or damaged in any way. Return to an authorized service facility for examination and repair.
3. This unit should always be kept in an upright position to avoid any damage. Locate the unit on a flat stable surface.
4. Check the voltage of the appliance matches the household voltage, which is located on the rating label.
5. Ensure that the air inlets and outlets are not blocked or covered.
6. Do not place the unit too close to curtains or other objects - min 30cm.
7. Make sure there are no objects near the unit which can prevent it from oscillating.
8. Never insert fingers, pencils or other objects into the unit if the power cord is plugged in, and especially not during the operation. Warn your children against these dangers.
9. This appliance can be used by children aged from 8 years and above if they have been given supervision or instruction concerning the use of the appliance in a safe way and understand

the hazards involved. Cleaning and user maintenance shall not be made by children unless they are older than 8 years and supervised.

10. Keep the appliance and its cord out of reach of children aged less than 8 years.
11. Children shall not play with the appliance.
12. Appliances can be used by persons with reduced physical, sensory or mental capabilities or lack of experience and knowledge if they have been given supervision or instruction concerning use of the appliance in a safe way and understand the hazards involved.
13. Unplug the unit from the socket when you do not use it. Please do not pull on the cord.
14. Do not use the unit near bath, shower, swimming pool or anywhere it could be splashed with water.
15. Do not expose the unit to direct sunlight.
16. The fan should stand upright during operation and never lying on its side.
17. Do not use the unit near flammable or explosive gases.
18. Before cleaning the unit, switch it off and unplug the power cord.
19. Do not leave the unit unattended during operating. Always unplug the power cord when not in use.
20. To repair the unit, take it to a qualified service engineer. Repairs carried out by unqualified people may cause damage to the unit or injury to persons or property and void the warranty.

APPLIANCE OVERVIEW

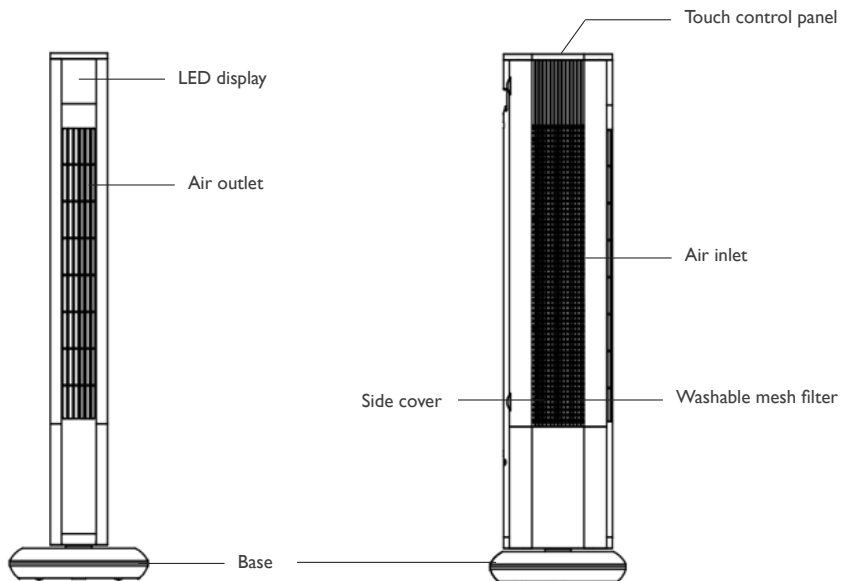

Control Panel and Remote control Symbols

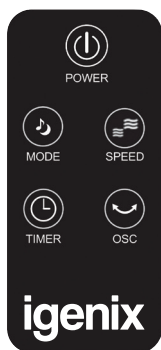

	Oscillation Function
	Breeze Mode: Normal, Natural (♫) and Sleep (♫)
	Timer: up to 8 hours Continuously press the button for 3 seconds, the time will increase in intervals of 1 hour (60 mins).
	Speed setting: 1 - 8
	Power: On and off control

Functions

1. Take the unit out of the box, removing any packaging. To activate the remote control, remove the pull tab from the battery compartment.
2. Connect the power cord to a plug socket.
3. Press the buttons on the control panel as follows:
 - POWER: Press the button to turn the unit on or off.
 - SPEED: Set the desirable fan speed (1 - 8).
 - MODE: Press the button to choose Normal, Natural (♫) or Sleep mode (♫).

- TIMER: Press the button to activate the timer function (0h – 8h). The set time will appear on LED Display. Continuously press the button for 3 seconds, the time will increase in 1 hour (60 mins) intervals.
 - OSC: Press the button to activate or deactivate the oscillation of the fan.
4. The Temperature LED display shows the room temperature and, after 15 seconds without operation, the brightness of the LED display will reduce by half.

Description of different Breeze Modes:

NORMAL MODE:

Constant wind speed as selected from your desired Speed Setting.

NATURAL BREEZE MODE:

The wind speed will randomly cycle through the fan speed settings from 1 to 8 and then from 8 to 1, repetitively, to simulate a natural breeze.

SLEEP BREEZE MODE:



The wind speed will randomly cycle through the fan speed settings, beginning at the set speed and gradually decreasing to speed 1, to simulate a comfortable sleeping breeze.

SETTING UP WI-FI FUNCTION

1. Setting up the igenix app

- Download the igenix app from the Apple store (for iOS devices) or from Google Play (for Android devices) and install the app on your device.
- Register your new igenix account and sign in to the app.

2. Pair the Tower Fan with your igenix app

- Plug in DF0038WIFI, press “POWER” to turn on the fan, then long press (approximately 6 seconds) “OSC” until you hear a beep and see the  symbol flash quickly (it is possible to connect the unit at this point), then long press (approximately 6 seconds) “MODE” until you hear a beep and see the  symbol begin to flash slowly.

NOTE: It is possible to connect the unit when the  symbol is flashing quickly, however it may be easier to connect it when the symbol is flashing slowly.

- Choose the ‘Devices’ option in the igenix app and then click on ‘Add device’ button.
- Follow the steps on your screen to add the device (fig.1)
- Once the device configuration is successful, you then have the option to rename the device.

Note: In order to successfully sync with your Amazon Echo, it is advised that you rename your device to an easily recognised word or phrase, such as ‘Tower Fan,’ as this will have a much greater compatibility with Alexa.

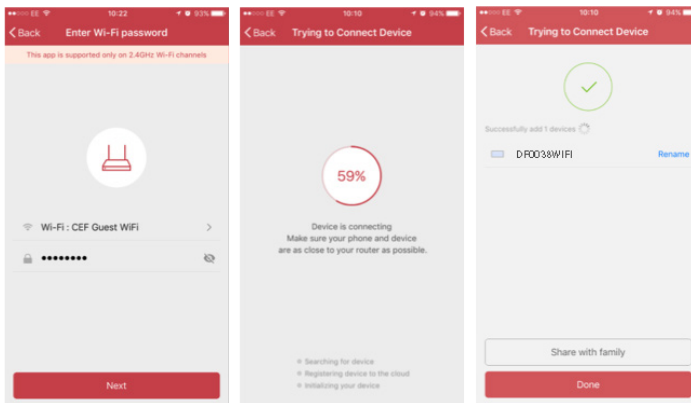

fig.1

SYNCING DEVICE WITH AMAZON ALEXA

1. Set up Amazon Echo and enable igenix app

- Search the ‘Amazon Alexa’ app from the Apple store (for iOS devices) or from Google Play (for Android devices) and install the app on your device.

Ia. Set up Echo with Alexa app

Note: You will need to purchase an Amazon Echo device to utilise this functionality. If you already have an echo device that is set up, you can skip this step.

- Plug your Echo device (Echo, Echo Tap or Echo Dot) into a power socket and turn it on.
- Make sure your Echo device is energized.
- Open the Alexa app by tapping the app icon on your mobile device.
- Register for an Amazon account, if you don't have one, or enter your Amazon account and password, then tap 'sign in' (fig. 2).

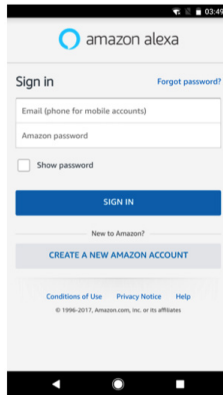

fig.2

- Select the Menu option in the top left corner (fig. 3), select 'Settings' (fig. 4) then tap 'SET UP A NEW DEVICE' (fig. 5).

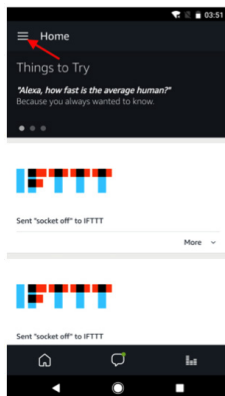

fig.3

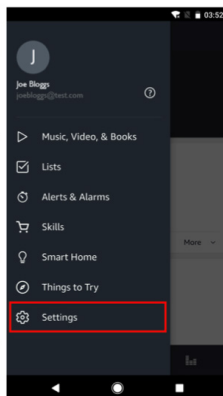

fig.4

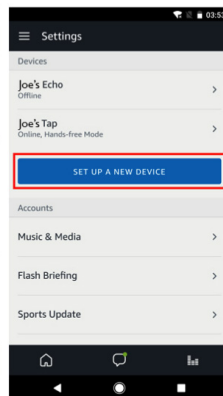

fig.5

- Select your Echo model (fig. 6), choose the appropriate language (fig. 7) and then tap 'CONNECT TO WI-FI' (fig. 8).

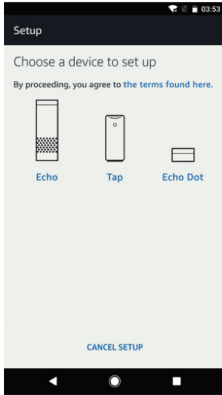

fig.6

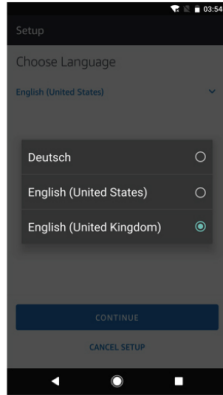

fig.7

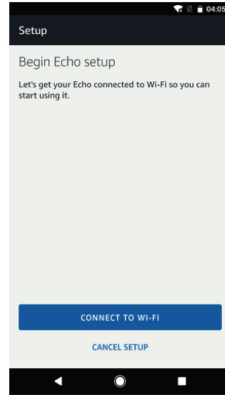

fig.8

- Long press the dot button on the top of your Echo device until the orange light shows up (fig. 9), and then tap 'CONTINUE'. When your device is connected to Echo, tap 'CONTINUE' (fig. 10-11).

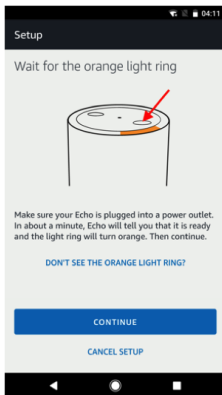

fig.9

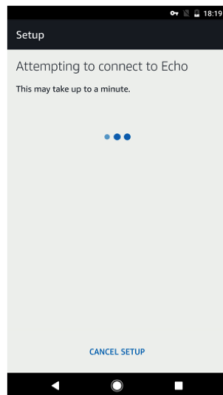

fig.10

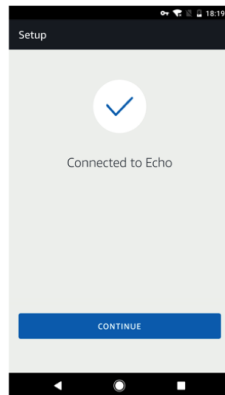

fig.11

- Select a Wi-Fi network to let Echo access the internet (fig. 12). Type in the Wi-Fi password and then tap 'CONNECT' (fig. 13). Echo may take several minutes to connect to the network (fig. 14).

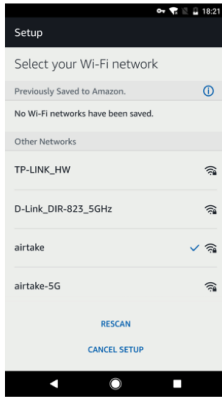

fig.12

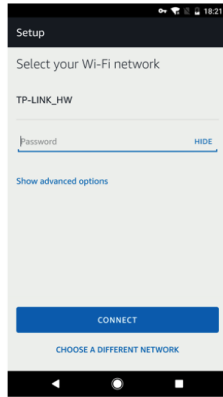

fig.13

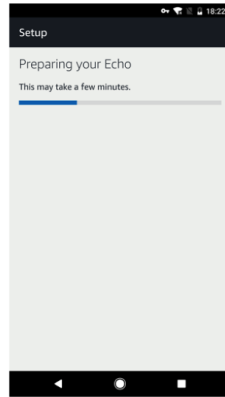

fig.14

- Tap 'CONTINUE' when Echo is connected to the network (fig. 15). After an introduction video, tap 'CONTINUE' to finish the setup (fig. 16).

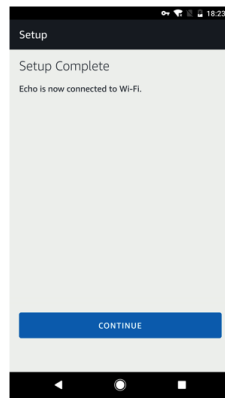

fig.15

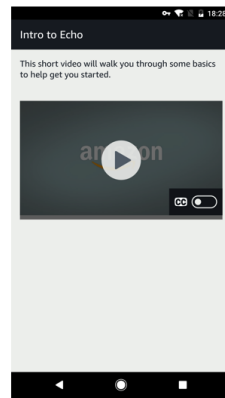

fig.16

Ib. Link igenix app account to Alexa app

- Select the Menu option in the top left corner (fig. 17), and then search ‘Smart Life’ (fig. 18). Select ‘igenix’ and tap ‘ENABLE’ to enable the skill.

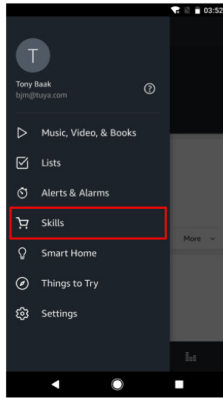

fig.17

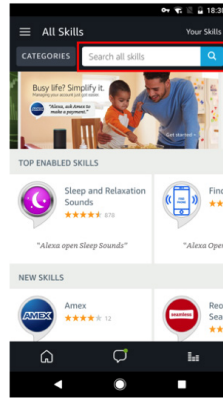

fig.18

- You will be redirected to the account link page.
- Type in your igenix account and password and then tap ‘Link Now’ to link your igenix account (fig. 19).

Note: The country, the account and the password must match the exact content in step 2.

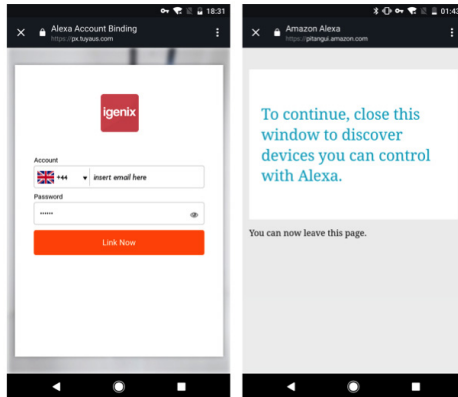

fig.19

2. Control your Tower Fan through Amazon Echo

2a. Discover your DF0038WIFI device

- Echo needs to discover your smart devices before it controls them.
- You can say ‘Alexa, discover devices’ to Echo. Then Echo will discover devices that have already been added in the igenix app.
- Alternatively you can select in the ‘Menu’ option ‘Smart Home’ (fig. 20), and then tap ‘DISCOVER’ to discover the smart devices (fig. 21). Discovered devices will be shown in the list (fig. 22).

Note: Every time you change the device’s name in the igenix app, Echo must rediscover before you can control them.

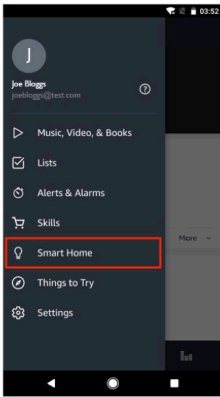

fig.20

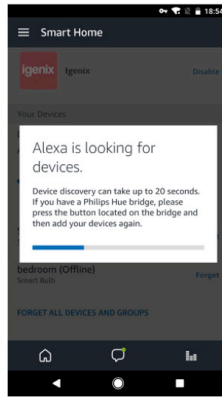

fig.21

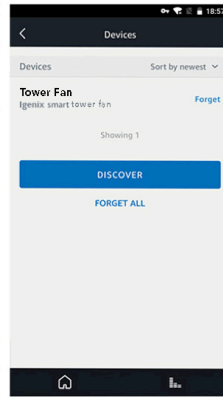
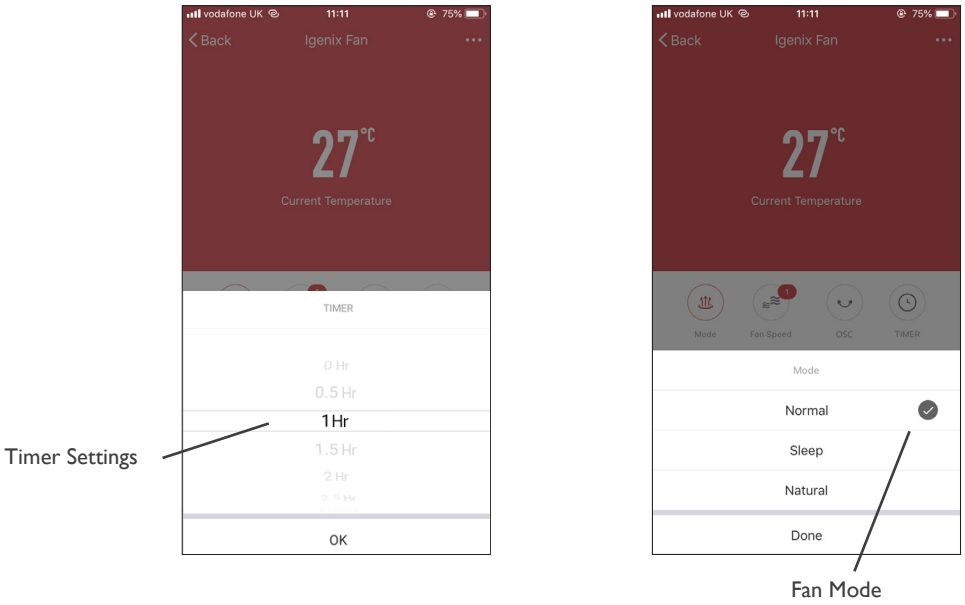
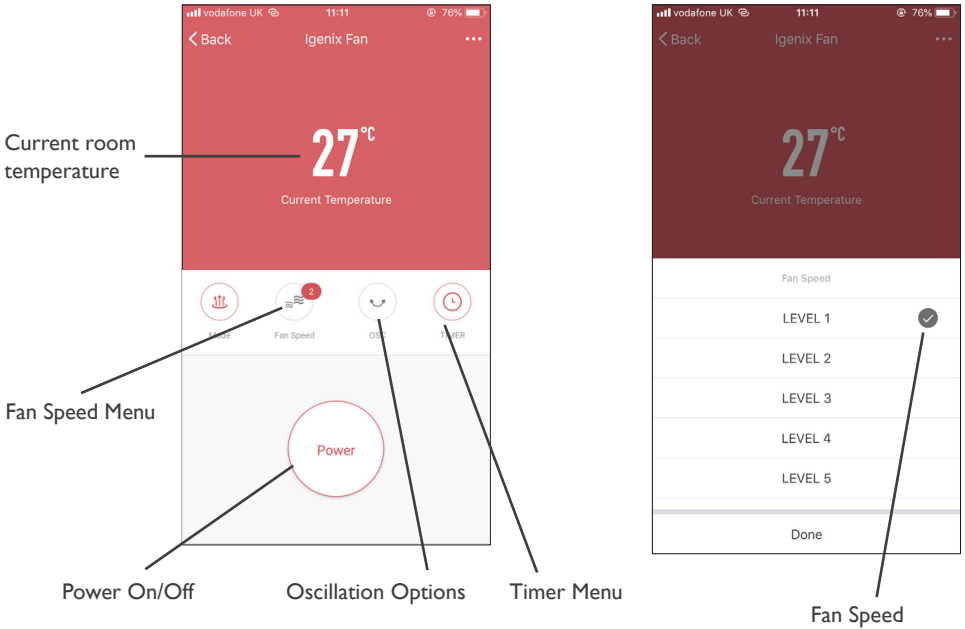

fig.22

2b. Control your Tower Fan by Voice Commands

- Now you can control your DF0038WIFI device through Echo. You can use the following commands to control your panel heater:
 - ‘Alexa, turn on tower fan’
 - ‘Alexa, set tower fan to 1, 2, 3 etc.’
 - ‘Alexa, turn off tower fan’

3. Control your Tower Fan through the igenix app



CLEANING AND STORAGE

- Before cleaning the unit turn the power off by pressing the POWER button, wait a few minutes and then unplug the power cord from the plug socket.
- Clean the unit using a damp cloth moistened with a mild soap solution, and then wipe it using a dry cloth.
- Gently remove the Filter Cover, than remove the Air Filter.
- Rinse the Filter under running water and dry it with a soft cloth.
- Replace the Air Filter and Filter Cover.
- We recommend cleaning the unit once a month.
- If you don't use the unit for a long period of time, please turn the unit off, unplug the power cord from the socket and then store in a dry, cool and safe place.
- Do not expose the unit to direct sunlight.
- Remove the batteries from the remote control and keep them safe.

MAINS PLUG FUSE REPLACEMENT

Fuse Replacement (Class I)

This appliance must be earthed. Remove the fuse cover with a small flat head screw driver. Take out the fuse and replace with a new fuse of the same Amp. Replace the fuse cover and push back into place.

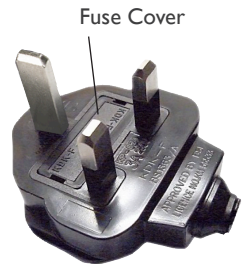

Igenix Warranty Terms & Conditions

This product is guaranteed for a period of 12 months as standard from the date of purchase against mechanical and electrical defects. You can extend your warranty for a further 12 months by registering your product.

Upon registration we will cover your product for a period of 24 months from the original purchase date against any mechanical or electrical defects.

To qualify for the guarantee, the product must be used for domestic household use only and in accordance with the instructions in the user manual. Any misuse of the product will result in the warranty being void.

The guarantee does not cover accidental damage, misuse, neglect, tampering or incorrect adjustment or installation.

The guarantee will be rendered invalid if the product is resold, has had its serial number removed (or has an invalid serial number), or if an unauthorised person has carried out any repairs or alterations.

The warranty does not cover accessories or consumable parts that require replacement under normal use. This includes shelving, dials, filters, belts and trays etc.

In the unlikely event of a breakdown please refer to the Troubleshooting guide in your user manual and check all plugs, fuses and the electricity supply.

If you still require assistance please contact our Customer Service department on **01473 271 272** or write to us at the following address:

**Customer Service Department
38 Bluestem Road, Ransomes Europark
Ipswich, IP3 9RR**

Please quote the Product Code which begins 'IG' or 'DF' and the Batch Code beginning '5' and give details of the exact fault. We will then decide whether to repair or replace the item.

Before we arrange the repair or replacement you will be required to return a copy of your proof of purchase. Please retain your original.

If an item is replaced within the agreed guarantee period, the guarantee for the replacement item will be calculated from the purchase date of the original.

In the event that the product is inspected and no fault is found or the product is not within the guarantee period you will be charged for the repair and any carriage costs.



Thank you for choosing Igenix

As a valued customer we would like to offer you a FREE 2 year warranty to cover your product against any electrical or mechanical defects.

This means that in the unlikely event you develop a fault or problem with your product we will happily repair or replace the item free of charge.

To qualify for the 2 year warranty you must register your product within 30 days of purchase. The full Terms & Conditions of our warranty policy are shown on the opposite page. They are also available on our website. **www.igenix.co.uk**

DISPOSAL INFORMATION



The European Directive 2012/19/EU on Waste Electrical and Electronic Equipment (WEEE), requires that old household electrical appliances must not be disposed of in normal unsorted municipal waste.

Old appliances must be collected separately in order to optimise the recovery and recycling of the materials they contain and reduce the impact on human health and the environment.

The crossed out “wheeled bin” symbol on the product reminds you of your obligation, that when you dispose of the appliance it must be separately collected. Consumers should contact their local authority or retailer for information concerning the correct disposal of their old appliance.

igenix

38 Bluestem Road, Ransomes Europark, Ipswich, IP3 9RR

Tel. 01473 271 272

Disclaimer: Igenix operate a policy of continual improvement and development. We therefore reserve the right to change/alter the specification and appearance of our appliances without prior notice. All diagrams and images shown in this manual are for illustration purposes only.